

# DS-8608/8616/8632NI-ST Embedded NVR

## HIKVision 8, 16 and 32 Channel Professional Network Video Recorder

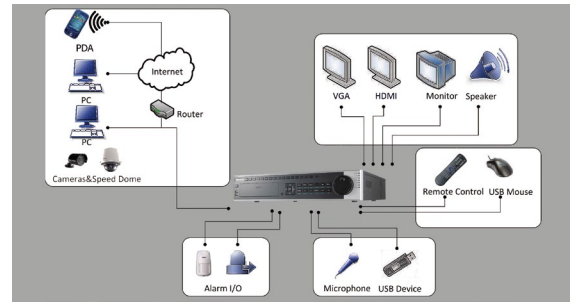

### Key features

- Third-party network cameras supported
- Up to 5 Megapixels resolution recording
- HDMI and VGA output at up to 1920×1080P resolution
- Up to 8 SATA interfaces
- HDD quota and group management

### Specifications

	DS-8608NI-ST	DS-8616NI-ST	DS-8632NI-ST
<b>Video / Audio input</b>			
IP video input	8-ch	16-ch	32-ch
Voice talk input	1-ch, BNC (2.0 Vp-p, 1kΩ)		
<b>Video / Audio output</b>			
Recording resolution	5MP /3MP /1080P /UXGA /720P /VGA /4CIF /DCIF /2CIF /CIF /QCIF		
CVBS output	1-ch, BNC (1.0 Vp-p, 75 Ω) Resolution: 704 × 576 (PAL); 704 × 480 (NTSC)		
HDMI output	1-ch, resolution: 1920 × 1080P /60Hz, 1920 × 1080P /50Hz, 1600 × 1200 /60Hz, 1280 × 1024 /60Hz, 1280 × 720 /60Hz, 1024 × 768 /60Hz		
VGA output	1-ch, resolution: 1920 × 1080P /60Hz, 1600 × 1200 /60Hz, 1280 × 1024 /60Hz, 1280 × 720 /60Hz, 1024 × 768 /60Hz		
Audio output	2-ch, BNC (Linear, 600Ω)		
Playback resolution	5MP /3MP /1080P /UXGA /720P /VGA /4CIF /DCIF /2CIF /CIF /QCIF		
Synchronous playback	8-ch	16-ch	16-ch
<b>Hard disk</b>			
SATA	Up to 8 SATA interfaces		
eSATA	1 eSATA interface		
Capacity	Up to 4TB capacity for each disk		
<b>External interface</b>			
Network interface	1 RJ-45 10 /100 /1000 Mbps self-adaptive Ethernet interface		
Serial interface	1 RS-232 interface (for parameters configuration, maintenance , transparent channel); 1 RS-485 interface (reserved); 1 RS-485 keyboard interface (for special keyboard control)		
USB interface	2, USB 2.0		
Alarm in	16		
Alarm out	4		
<b>General</b>			
Power supply	100~240 VAC, 6.3A, 50~60Hz		
Consumption	≤ 35W	≤ 40W	≤ 45W
Working temperature	-10 °C ~ +55 °C		
Working humidity	10%~90%		
Chassis	19-inch rack-mounted 2U chassis		
Dimensions (W × D × H)	445 × 470 × 90 mm (17.52" × 18.5" × 3.54")		
Weight	≤ 8 kg ( without hard disk or DVD-R/W )		

### Rear Panel of DS-8600NI-ST



1. Video out
2. CVBS audio out, VGA audio out
3. Line in
4. RS-232 serial interface
5. VGA interface
6. HDMI interface
7. eSATA interface
8. LAN network interface
9. Termination switch
10. RS-485 serial interface, keyboard interface, alarm in, alarm out
11. GND
12. 100~240VAC power input
13. Power switch