

GEOVISION GV-VD220 2 MEGA-PIXEL IP NETWORK CAMERA



- 1/2.5" progressive scan CMOS
- Dual video streams from two of H.264, MPEG4 and MJPEG
- Up to 30 fps at 1920 x 1080
- IK10+ (for GV-VD220D and GV-VD221D only)
- IP66 compliant
- 3-axis mechanism (pan / tilt / roll)
- External microphone
- Built-in IR LED
- 2-way audio
- One sensor input and alarm output
- TV-out support
- Micro SD/SDHC Card Slot
- Motion detection
- Tampering alarm
- Privacy mask
- IP address filtering
- 3GPP / ISMA
- DC 12V / AC 24V / PoE
- Day / Night function
- Varifocal megapixel lens
- 16 languages on Web interface

Models

| Model | Housing Cover Cover Color | Vandal Resistance |
|-----------|------------------------------|-------------------|
| GV-VD220D | Transparent cover | IK10+ |
| GV-VD221D | Smoked cover | IK10+ |
| GV-VD222D | Transparent cover | IK7 |
| GV-VD223D | Smoked cover | IK7 |

Active Tampering Alarm

Tampered



Focus Change



Camera Shift

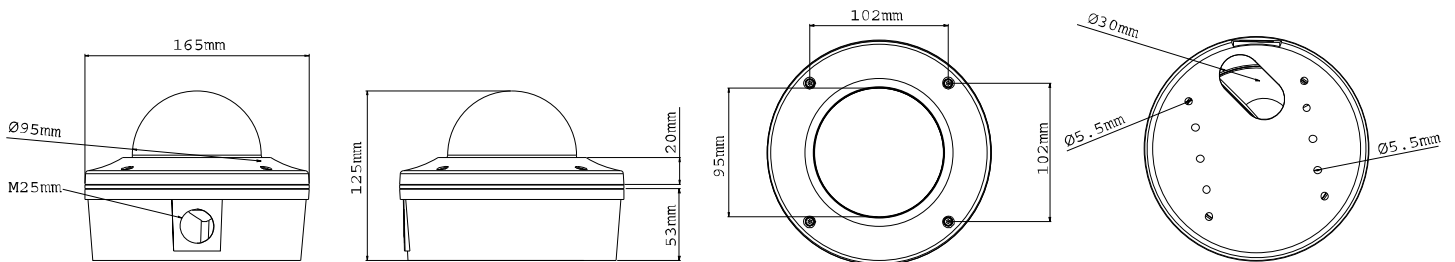

SPECIFICATIONS

| Camera | | |
|----------------------|---------------|--|
| Image Sensor | | 1/2.5" progressive scan CMOS |
| Picture Elements | | 1920 (H) x 1080 (V) |
| Minimum Illumination | Color | 1 Lux (1/30 sec), 0.5 Lux (1/5 sec) |
| | B/W IR ON | 0 Lux |
| Shutter Speed | | Automatic, Manual (1/5 ~ 1/8000 sec) |
| White Balance | | Automatic, Manual (2800K ~ 8500K) |
| Lens | | |
| Megapixel | | Yes |
| Day / Night support | | Yes |
| Max Aperture | | F/1.3 ± 5% |
| Focal Length | | 2.7 ~ 9 mm |
| Field of view | Diagonal | 101° (W) ~ 32° (T) ± 5° |
| | Horizontal | 88° (W) ~ 27.9° (T) ± 5° |
| | Vertical | 49.7° (W) ~ 15.7° (T) ± 5° |
| Operation | Focus | Manual (w / lock) |
| | Zoom | Manual (w / lock) |
| | Iris | DC |
| IR LED Quantity | | 15 IR LEDs |
| IR Distance | | 15 m / 50 ft (Max.) |
| Operation | | |
| Video Codec | | H.264, MPEG4, MJPEG |
| Video Streaming | | Dual Streams from two of H.264, MPEG4 and MJPEG |
| Frame Rate | | 30 fps at 1920 x 1080 * The frame rate and the performance may vary depending on the number of connections and data bitrates (different scenes). |
| Image Setting | | Brightness, Contrast, Sharpness, Gamma, White Balance, Flicker-less, Image Orientation, Backlight Compensation |
| Audio Codec | | G.711, AAC (16kHz / 16 bit) * AAC is only supported by GV-System V8.5 or later. |
| Sensor Input | | 1 Input (Dry Contact) |
| Alarm Output | | 1 Digital Output |
| Video Resolution | | |
| Main Stream | 4:3 | 1600 x 1200, 1280 x 960, 640 x 480, 320 x 240 |
| | 16:9 | 1920 x 1080, 1280 x 720, 640 x 360, 448 x 252 |
| | 5:4 | 1280 x 1024, 640 x 512, 320 x 256 |
| Sub Stream | 4:3 | 640 x 480, 320 x 240 |
| | 16:9 | 640 x 360, 448 x 252 |
| | 5:4 | 640 x 512, 320 x 256 |
| Network | | |
| Interface | | 10/100 Ethernet |
| Ethernet Protocol | | HTTP, HTTPS, TCP, UDP, SMTP, FTP, DHCP, NTP, UPnP, DynDNS, 3GPP/ISMA, RTSP, PSIA, SNMP, QoS(DSCP) |
| Mechanical | | |
| Lens Mounting | | ø 14 mm |
| Rotation Axis | | 3-axis (pan / tilt / roll) |
| Connectors | Power | 3-pin terminal block |
| | Ethernet | RJ-45 |
| | Audio | 1 In (RCA female for microphone) 1 Out (RCA female for speaker) |
| | Digital I/O | I/O Wires |
| | Auto Iris | DC drive |
| | Local Storage | Micro SD/SDHC memory card slot |
| | TV-Out | BNC connector * The TV-Out function only works in 640 x 480 resolution. For TV-Out to work properly, you must set the video resolution to 1280 x 1024 or lower. If both streams are enabled, the Sub Stream must be set to 640 x 480. |

| General | | |
|----------------------------|--|-------|
| Operating Temperature | -20 °C ~ 50 °C / -4 °F ~ 122 °F | |
| Humidity | 10% to 90% (no condensation) | |
| Power Source | 12V DC / 24V AC / PoE | |
| Power Consumption | 12 W (max. 1A at 12V DC) | |
| Regulatory | CE, FCC, C-Tick, RoHS compliant | |
| Dimensions (L X W X H) | ø 165 x 125 mm / 6.49 x 4.92 in | |
| Weight | 1.7 kg / 3.75 lb | |
| Protection Classification | IP66 | |
| Vandal Resistance | GV-VD220D / GV-VD221D | IK10+ |
| | GV-VD222D / GV-VD223D | IK7 |
| Power over Ethernet | | |
| PoE Standard | IEEE 802.3af Power over Ethernet / PSE | |
| PoE Power Supply Type | End-Span | |
| PoE Power Output | Per Port 48V DC, 350mA. Max. 15.4 watts | |
| Web Interface | | |
| Installation Management | Web-based configuration | |
| Maintenance | Firmware upgrade through Web Browser or Utility | |
| Access from Web Browser | Camera live view, video recording, change video quality, bandwidth control, image snapshot, digital I/O control, audio, Picture in Picture, Picture and Picture, Privacy Mask, Visual Automation, Tampering Alarm, Wide Angle Lens Dewarping | |
| Language | Czech / Danish / English / French / German / Hebrew / Hungarian / Italian / Japanese / Polish / Portuguese / Russian / Serbian / Simplified Chinese / Spanish / Traditional Chinese | |
| Applications | | |
| Network Storage | GV-NVR, GV-System | |
| 3G Mobile Phone | Built-in player for 3GPP / ISMA | |
| Live Viewing | IE , Mobile Phone | |
| CMS Server support | GV-Control Center, GV-Center V2, GV-VSM, GV-Backup Center, GV-Video Gateway, GV-Recording Server | |

Note: Specifications are subject to change without notice.